



**WHANGANUI  
DISTRICT COUNCIL**  
Te Kaunihera a Rohe o Whanganui

# **Public Places, Parks and Reserves Bylaw 2023**

## **Submissions Received**

# Public Parks, Places, and Reserves

Speaking

**ID** 4  
**reference** 213060933231119  
**First name** Rachael Frances  
**Last name** Hampton

## KEY ISSUES

### Do you agree that a public places bylaw is still required to manage public places?

I support keeping a bylaw controlling public places

### Please tell us your reasons for your response.

Who should use the park, and putting a gate or chain to keep out the boyracers to maintain the beauty of the park.

### Do you support the updated bylaw?

I neither support nor oppose the proposed bylaw

### What do you think are the main issues which the bylaw should regulate?

Both, I don't want any damage to our beautiful park.

### If a fixed base fee or sliding fee is chosen, Please rate the below options as to how important you think they should be in setting a booking fee.

#### Who is making the booking (private business, community group, not-for-profit, etc)

Vital

#### Which place is being booked (Majestic Square, Virginia Lake, etc)

Neither important nor unimportant

#### Whether alcohol is being provided or sold

Not important

#### Expected nuisance to other users (noise, smell, etc)

Important

#### Any anticipated damage to the space or maintenance required (grass, footpaths, facilities, etc)

Important

### Do you think we have left any important factors out?

Addressing vehicle's on park (boyracer's). Only dog walkers + council staff allowed.

## Attachments

Rachael Hampton Submission Attachment.pdf

## Submission method

Delivered

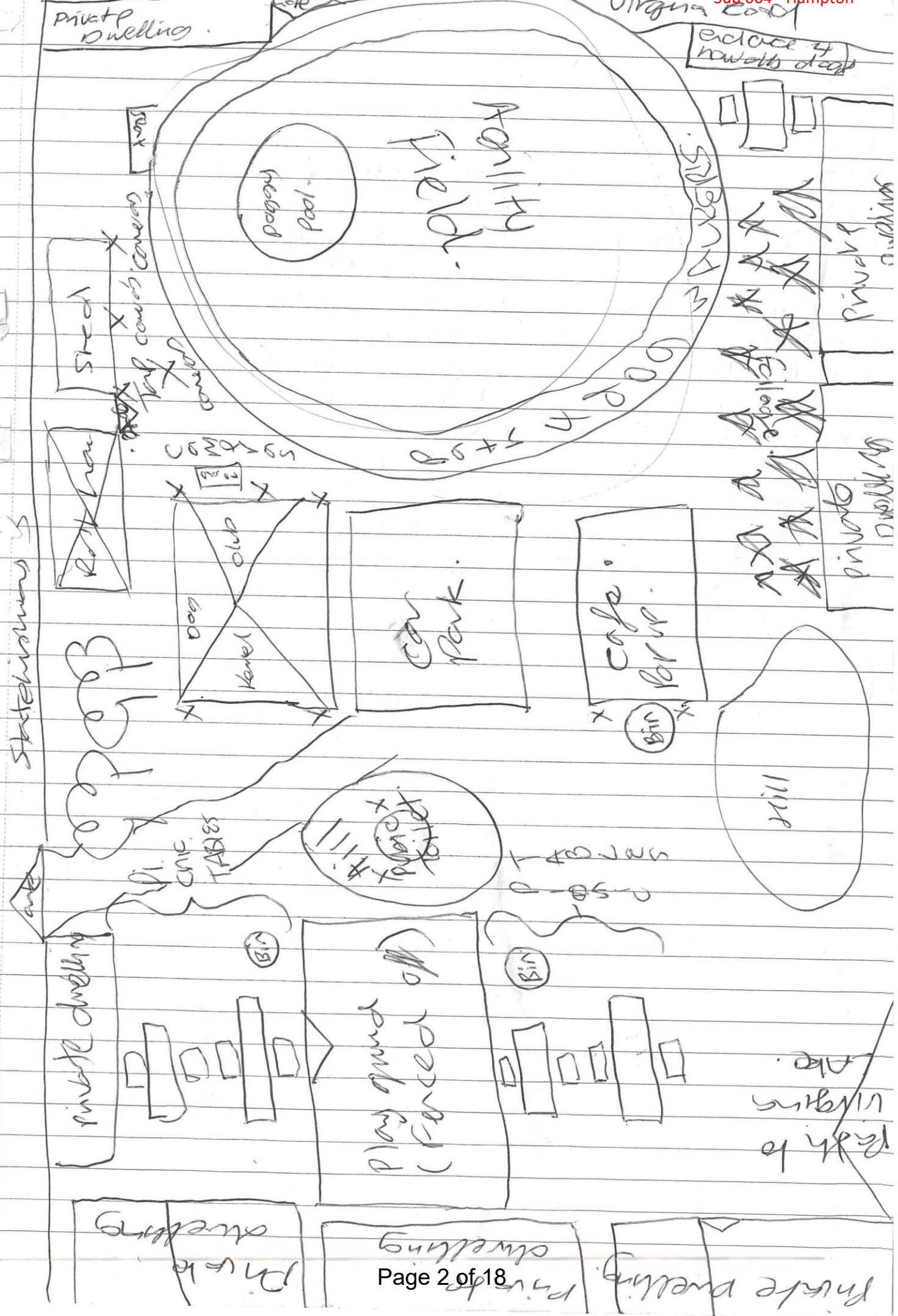

# Public Parks, Places, and Reserves

Not Speaking

ID 1  
reference 316061113235615  
First name Jan  
Last name Pavarno

## KEY ISSUES

### Do you agree that a public places bylaw is still required to manage public places?

I support keeping a bylaw controlling public places

### Please tell us your reasons for your response.

Wanganui needs someone to take a strong stand on the abuse of public places around Castlecliff. The beach reserve is used as a place for cars to do 'donuts' and generally tear up as much of the ground as possible. Rubbish is regularly dumped all around the carparks and on the reserve as well as in Morgan Street. Motor bikes and trail bikes are tearing up and down the reserve and through the dunes, ripping up the plants and grass and endangering walkers and beach users.

### Do you support the updated bylaw?

I support the changes proposed to the bylaw

### Please tell us your reasons for your response.

Council needs to go further and prohibit the use of vehicles in the dunes and on the beach reserve. Just putting up signs is a waste of time. There needs to be knee breaker fences along the beach reserve and barriers at all entries to the dunes. There needs to active education through schools and motor bike clubs, also the use of educational signs.

### What do you think are the main issues which the bylaw should regulate?

Damage to parks, noise nuisance, health and safety of people who would like to use the dunes and the reserve without endangering their health, protecting the very fragile dunes ecology.

### If a fixed base fee or sliding fee is chosen, Please rate the below options as to how important you think they should be in setting a booking fee.

Who is making the booking (private business, community group, not-for-profit, etc)

Which place is being booked (Majestic Square, Virginia Lake, etc)

Whether alcohol is being provided or sold

Expected nuisance to other users (noise, smell, etc)

Any anticipated damage to the space or maintenance required (grass, footpaths, facilities, etc)

Do you think we have left any important factors out?

Submission method Online

## Public Parks, Places, and Reserves

**ID** 2  
**reference** 545060935234616  
**First name** Heather  
**Last name** Cox  
**Organisation** New Zealand Masters Games  
**Role** Games Manager

Not Speaking

### KEY ISSUES

#### Do you agree that a public places bylaw is still required to manage public places?

I support keeping a bylaw controlling public places

#### Please tell us your reasons for your response.

To manage how these spaces are utilised.

#### Do you support the updated bylaw?

I support the changes proposed to the bylaw

#### What do you think are the main issues which the bylaw should regulate?

All of the above - "protecting our parks"

Ensuring that how people/groups use and treat the spaces is in keeping with our heritage and culture.

#### What sort of fee do you think should be charged for bookings?

I support a sliding fee (starting at free)

#### Please tell us your reasons for your response.

- Removing barriers for community groups
- Establishing equitable access
- Recognition of parks as a "venue" for commercial groups e.g., it would cost a lot more to hire a hall

#### If a fixed base fee or sliding fee is chosen, Please rate the below options as to how important you think they should be in setting a booking fee.

#### Who is making the booking (private business, community group, not-for-profit, etc)

Vital

#### Which place is being booked (Majestic Square, Virginia Lake, etc)

Vital

#### Whether alcohol is being provided or sold

Vital

#### Expected nuisance to other users (noise, smell, etc)

Vital

#### Any anticipated damage to the space or maintenance required (grass, footpaths, facilities, etc)

Vital

#### Do you think we have left any important factors out?

Details on intended use

#### Please tell us your reasons for your responses.

The options are standard requirements, and I don't see why any should be left out or considered less important regardless of who is using the space.

**Submission method** Online

# Public Parks, Places, and Reserves

**ID** 3  
**reference** 218061042231116  
**First name** Andrew  
**Last name** Savage  
**Organisation** YMCA Central  
**Role** Regional Manager

Not Speaking

## KEY ISSUES

### Do you agree that a public places bylaw is still required to manage public places?

I support keeping a bylaw controlling public places

### Please tell us your reasons for your response.

I think it's critical that we have a means of monitoring what is happening on public lands, e.g. how and when public parks etc. are used.

### Do you support the updated bylaw?

I support the changes proposed to the bylaw

### Please tell us your reasons for your response.

To ensure the general public understand the use of our public spaces is important as it ensures appropriate use of spaces. It also means that it can be more easily determined how private vs public usage is tracked/monitored ensuring a fair pricing structure and use is in place.

### What do you think are the main issues which the bylaw should regulate?

Honestly there's a range of things it should cover. Usage, private vs public. How and when it is used, the cost for private vs public for profit use etc.

Health and safety is a given, especially as it relates to usage by children, whanau etc.

### What sort of fee do you think should be charged for bookings?

I support a sliding fee (starting at free)

### Please tell us your reasons for your response.

A sliding fee allows for small groups, non profits etc to be able to access and afford a space. However, a commercial user should pay a higher rate as they are likely using a larger portion of space, e.g., the gypsy fair, and it's for commercial reasons.

### If a fixed base fee or sliding fee is chosen, Please rate the below options as to how important you think they should be in setting a booking fee.

#### Who is making the booking (private business, community group, not-for-profit, etc)

Vital

#### Which place is being booked (Majestic Square, Virginia Lake, etc)

Vital

#### Whether alcohol is being provided or sold

Vital

#### Expected nuisance to other users (noise, smell, etc)

Vital

#### Any anticipated damage to the space or maintenance required (grass, footpaths, facilities, etc)

Vital

#### Do you think we have left any important factors out?

Submission method

Online

## Public Parks, Places, and Reserves

Not Speaking

<b>ID</b>	5
<b>reference</b>	851061503233919
<b>First name</b>	Danny
<b>Last name</b>	Jonas
<b>Organisation</b>	Sport Whanganui
<b>Role</b>	Chief Executive

### KEY ISSUES

#### Do you agree that a public places bylaw is still required to manage public places?

I support keeping a bylaw controlling public places

#### Do you support the updated bylaw?

I support the changes proposed to the bylaw

#### What sort of fee do you think should be charged for bookings?

I support a sliding fee (starting at free)

#### Please tell us your reasons for your response.

The \$50 park booking fee is currently a barrier to community groups, including Sport Whanganui, using our parks and public spaces. Removing the fee for community groups will enable our parks to be better used for organised events that help our community get outside, connect and celebrate different aspects of life in Whanganui.

#### If a fixed base fee or sliding fee is chosen, Please rate the below options as to how important you think they should be in setting a booking fee.

#### Who is making the booking (private business, community group, not-for-profit, etc)

Vital

#### Which place is being booked (Majestic Square, Virginia Lake, etc)

Neither important nor unimportant

#### Whether alcohol is being provided or sold

Neither important nor unimportant

#### Expected nuisance to other users (noise, smell, etc)

Neither important nor unimportant

#### Any anticipated damage to the space or maintenance required (grass, footpaths, facilities, etc)

Important

#### Do you think we have left any important factors out?

The length of time a booking is for (eg an afternoon vs. several days)

#### Please tell us your reasons for your responses.

Non-profit groups and schools are typically trying to further kaupapa that benefits the community. It is in our collective best interest in enable them to use our public parks to deliver their mahi, raise their profiles and celebrate with their communities. We support removing any barriers to this.

Damage should be considered only when it is above and beyond what could be expected from maximum use of a park. For example a school group playing sport at Peat Park may damage the grass, but this should be judged against what would be expected at a well-used sports field.

#### Submission method

Online

## Public Parks, Places, and Reserves

**ID** 6  
**reference** 756061217232720  
**First name** Hakeke Street  
**Last name** Community Centre  
**Organisation** Hakeke Street Community Centre  
**Role** Manager

Not Speaking

### KEY ISSUES

#### Do you agree that a public places bylaw is still required to manage public places?

I support keeping a bylaw controlling public places

#### Please tell us your reasons for your response.

There needs to be some control regulating behaviour in public spaces.

#### Do you support the updated bylaw?

I support the changes proposed to the bylaw

#### What do you think are the main issues which the bylaw should regulate?

damage to parks, health and safety eg: no car skids on the grounds which could be achieved by fencing parks so approval is needed to access vehicle points.

#### What sort of fee do you think should be charged for bookings?

I support a sliding fee (starting at free)

#### Please tell us your reasons for your response.

community groups should be able to hold events for the community at no cost particularly if no entry fee is requested and no money being made. The fee can prohibit organisations wishing to do a community event, from doing so.

#### If a fixed base fee or sliding fee is chosen, Please rate the below options as to how important you think they should be in setting a booking fee.

#### Who is making the booking (private business, community group, not-for-profit, etc)

Vital

#### Which place is being booked (Majestic Square, Virginia Lake, etc)

Important

#### Whether alcohol is being provided or sold

Important

#### Expected nuisance to other users (noise, smell, etc)

Vital

#### Any anticipated damage to the space or maintenance required (grass, footpaths, facilities, etc)

Important

#### Do you think we have left any important factors out?

Submission method

Online



## Public Parks, Places, and Reserves

**ID** 7  
**reference** 355061341235723  
**First name** Aimee  
**Last name** Loveridge  
**Organisation** West Cluster Country schools  
**Role** Sports Coordinator

Not Speaking

### KEY ISSUES

**Do you agree that a public places bylaw is still required to manage public places?**

I neither support nor oppose having a bylaw

**Do you support the updated bylaw?**

I neither support nor oppose the proposed bylaw

**What sort of fee do you think should be charged for bookings?**

I support no fee for all users

**Please tell us your reasons for your response.**

I oppose having to pay to use a public park as a one off event for our tamariki - it is a large cost for us to provide these sporting opportunities for our tamariki and something that should be waived.

**If a fixed base fee or sliding fee is chosen, Please rate the below options as to how important you think they should be in setting a booking fee.**

**Who is making the booking (private business, community group, not-for-profit, etc)**

Irrelevant

**Which place is being booked (Majestic Square, Virginia Lake, etc)**

Irrelevant

**Whether alcohol is being provided or sold**

Vital

**Expected nuisance to other users (noise, smell, etc)**

Vital

**Any anticipated damage to the space or maintenance required (grass, footpaths, facilities, etc)**

Vital

**Do you think we have left any important factors out?**

**Please tell us your reasons for your responses.**

I oppose having to pay to use a public park as a one off event for our tamariki - it is a large cost for us to provide these sporting opportunities for our tamariki and something that should be waived.

**Council will also retain several other ways of managing fees, such as the ability to waive them entirely, or take refundable deposits. If you want to make any comment on these, please do so here.**

Waiver the fee for school sporting events

**Submission method** Online

## Public Parks, Places, and Reserves

**ID** 8  
**reference** 196061926230324

Not Speaking

**First name** Ruth  
**Last name** Tidemann

### KEY ISSUES

#### Do you agree that a public places bylaw is still required to manage public places?

I support keeping a bylaw controlling public places

#### Please tell us your reasons for your response.

The coastal dunes are damaged daily, and not just once but many times sometimes in a day. Council has said they will look after the coast for the future of our tamariki. We need controls as some people are lawless. And these teach what we do not want

#### If a fixed base fee or sliding fee is chosen, Please rate the below options as to how important you think they should be in setting a booking fee.

Who is making the booking (private business, community group, not-for-profit, etc)

Which place is being booked (Majestic Square, Virginia Lake, etc)

Whether alcohol is being provided or sold

Expected nuisance to other users (noise, smell, etc)

Any anticipated damage to the space or maintenance required (grass, footpaths, facilities, etc)

Do you think we have left any important factors out?

#### Further comments

Why don't you charge fees for quads/bikes??

**Submission method** Online

# Public Parks, Places, and Reserves

Not Speaking

ID 9  
reference 402061229235026  
First name Alex  
Last name Churchill

## KEY ISSUES

**Do you agree that a public places bylaw is still required to manage public places?**

I support keeping a bylaw controlling public places

**Do you support the updated bylaw?**

I support the changes proposed to the bylaw

**Please tell us your reasons for your response.**

standards of behavior can be enforced in public places

**What do you think are the main issues which the bylaw should regulate?**

damage to parks

**What sort of fee do you think should be charged for bookings?**

I support a sliding fee (starting at free)

**Please tell us your reasons for your response.**

I think it makes sense that large groups should book and be charged a fee.

**If a fixed base fee or sliding fee is chosen, Please rate the below options as to how important you think they should be in setting a booking fee.**

**Who is making the booking (private business, community group, not-for-profit, etc)**

Important

**Which place is being booked (Majestic Square, Virginia Lake, etc)**

Neither important nor unimportant

**Whether alcohol is being provided or sold**

Important

**Expected nuisance to other users (noise, smell, etc)**

Vital

**Any anticipated damage to the space or maintenance required (grass, footpaths, facilities, etc)**

Important

**Do you think we have left any important factors out?**

Submission method

Online

# Public Parks, Places, and Reserves

ID 10  
reference 106061049234327  
First name Daniel  
Last name Comp

Not Speaking

## KEY ISSUES

### Do you agree that a public places bylaw is still required to manage public places?

I support keeping a bylaw controlling public places

### Do you support the updated bylaw?

I neither support nor oppose the proposed bylaw

### Please tell us your reasons for your response.

I think if we look at the purpose of the booking or activity i.e usage,type I agree that there should be a cost for all private users who make a profit off a free asset so it can cover any potential loss ,damage to the council asset but also it pools into a fund that can be distributed to cover non for profit,charity organisations as a moral belief they are community minded organisations with free access that should be excluded from all costs including booking fee's.

### What do you think are the main issues which the bylaw should regulate?

Damage,Lawfulness,Heath and Safety and Monitor on the weekends when the fields and parks are at most use.

### What sort of fee do you think should be charged for bookings?

I support a sliding fee (starting at free)

### Please tell us your reasons for your response.

As above comment only for private and not at all all for community non for profit organisations.

### If a fixed base fee or sliding fee is chosen, Please rate the below options as to how important you think they should be in setting a booking fee.

#### Who is making the booking (private business, community group, not-for-profit, etc)

Neither important nor unimportant

#### Which place is being booked (Majestic Square, Virginia Lake, etc)

Important

#### Whether alcohol is being provided or sold

Vital

#### Expected nuisance to other users (noise, smell, etc)

Vital

#### Any anticipated damage to the space or maintenance required (grass, footpaths, facilities, etc)

Vital

#### Do you think we have left any important factors out?

Nah covered about it.

### Please tell us your reasons for your responses.

Passionate citizen born in Whanganui.

### Council will also retain several other ways of managing fees, such as the ability to waive them entirely, or take refundable deposits. If you want to make any comment on these, please do so here.

It will depend on the communication,wording on waiving.

#### Submission method

Online

## Public Parks, Places, and Reserves

Not Speaking

<b>ID</b>	11
<b>reference</b>	650061411231828
<b>First name</b>	Judith
<b>Last name</b>	Mellsop
<b>Organisation</b>	Whanganui Riverbank parkrun
<b>Role</b>	Event Director

### KEY ISSUES

#### Do you agree that a public places bylaw is still required to manage public places?

I support keeping a bylaw controlling public places

#### Do you support the updated bylaw?

I support the changes proposed to the bylaw

#### What sort of fee do you think should be charged for bookings?

I support a sliding fee (starting at free)

#### Please tell us your reasons for your response.

Community events should have free use of parks as they are open to the public and are providing a service. parkrun should come into this category. It is a public, free for ever event run by volunteers worldwide which encourages a wide range of people to exercise, socialize and volunteer in the outdoors. parkrun does not expect exclusive use of the park or walkway and we mention in our weekly briefing that we are sharing the area with the public.

On at least two occasions when parkrun (I was acting on behalf of parkrun Asia/Pacific) applied for a license to use a small unnamed park and part of the Mountains to the Sea Cycleway/Walkway there was uncertainty about what groups could be charged a fee and when this fee could be waived and who could make this decision. Eventually the parkrun Asia/Pacific leadership and a member of WDC executive leadership became involved to resolve the issue of fee payment. Schools should also be able to book facilities for free, E.g. Bason Reserve BBQs.

#### If a fixed base fee or sliding fee is chosen, Please rate the below options as to how important you think they should be in setting a booking fee.

#### Who is making the booking (private business, community group, not-for-profit, etc)

Vital

#### Which place is being booked (Majestic Square, Virginia Lake, etc)

Important

#### Whether alcohol is being provided or sold

Important

#### Expected nuisance to other users (noise, smell, etc)

Important

#### Any anticipated damage to the space or maintenance required (grass, footpaths, facilities, etc)

Important

#### Do you think we have left any important factors out?

Length of event

#### Please tell us your reasons for your responses.

There is a big difference between a community group using an area for a couple of hours to support our community and a commercial enterprise having exclusive use of an area for several days.

#### Council will also retain several other ways of managing fees, such as the ability to waive them entirely, or take refundable deposits. If you want to make any comment on these, please do so here.

If fees are waived the process needs to be consistent, clear and transparent.

#### Further comments

## Public Parks, Places, and Reserves

We are grateful that WDC allows us to use outdoor areas for parkrun which benefits our local community and also brings visitors to town. We are lucky to have a spacious, scenic, central, well-maintained park and wide walkway where we can stage a weekly 5km event without crossing roads.

**Submission method**

Online

# Public Parks, Places, and Reserves

<b>ID</b>	12
<b>reference</b>	143061254234030
<b>First name</b>	Christina
<b>Last name</b>	Emery
<b>Organisation</b>	Pride Whanganui
<b>Role</b>	Trustee

Not Speaking

## KEY ISSUES

### Do you agree that a public places bylaw is still required to manage public places?

I support keeping a bylaw controlling public places

### Please tell us your reasons for your response.

The community that we support is an underrepresented minority and one that continues to be targeted consistently, not only nationwide but in Whanganui as well. A lot of our events are in public spaces, we want to ensure that if anything were to happen or any threats were to be made then our community is safe knowing that the bylaws set down by their local Council keep them free from harm. In terms of our organisation, bylaws are important for public places for several reasons

1. **Maintaining Order:** Bylaws establish rules and regulations that help maintain order in public spaces. These rules ensure that everyone can enjoy these spaces safely and responsibly. By defining acceptable behavior, such as discouraging littering, vandalism, hate speech or unsatisfactory behaviours, bylaws contribute to the overall safety and wellbeing of those who use public areas.
2. **Facilitating Fair and Equitable Use:** Bylaws establish guidelines for the shared use of public spaces, ensuring that everyone has an equal opportunity to utilize them. By addressing factors such as space allocation, usage restrictions, and reservation protocols for events or facilities, bylaws prevent overcrowding and promote fair access for all members of the community.
3. **Providing Legal Framework:** Bylaws act as a legal framework that allows governing entities to enforce rules and regulations within public spaces. They provide a means to address non-compliance and enforce penalties for violations. This legal framework enables authorities to maintain order, resolve disputes, and protect the rights and interests of individuals using public spaces.

Bylaws are crucial for public spaces as they establish clear rules, promote safety, ensure equitable use, preserve natural environments, encourage community engagement, and provide a legal framework for enforcement. By upholding these regulations, public spaces can be enjoyable, safe, and accessible to all members of the community.

### Do you support the updated bylaw?

I support the changes proposed to the bylaw

### Please tell us your reasons for your response.

We support making the fee structure a sliding scale as represented in the submission. Fostering an environment where our NFP or community orgs can promote what they do and bring the community together - with little to no fee is invaluable. Creating a pricing structure for those who turn profit based on what they're doing publicly is fair and equitable, however we support fees that are obtainable rather than those that will see regular commercial users no longer use the spaces.

### What do you think are the main issues which the bylaw should regulate?

From our point of view, safety for our community, which comes in many forms. Regulations need to be looked into for those being a nuisance at our events, those perpetrating hate speech toward ours or other community groups or those running events that target ours or another group. A booking should be able to be denied or terminated based on the likelihood to incite these things.

### What sort of fee do you think should be charged for bookings?

I support a sliding fee (starting at free)

## Public Parks, Places, and Reserves

### **Please tell us your reasons for your response.**

Fostering an environment where our NFP or community orgs can promote what they do and have an opportunity to bring the community together - with little to no fee, is invaluable. Creating a pricing structure for those who turn profit based on what they're doing publicly is fair and equitable, however we support fees that are obtainable rather than those that will see regular commercial users no longer use the spaces.

**If a fixed base fee or sliding fee is chosen, Please rate the below options as to how important you think they should be in setting a booking fee.**

### **Who is making the booking (private business, community group, not-for-profit, etc)**

Vital

### **Which place is being booked (Majestic Square, Virginia Lake, etc)**

Neither important nor unimportant

### **Whether alcohol is being provided or sold**

Vital

### **Expected nuisance to other users (noise, smell, etc)**

Neither important nor unimportant

### **Any anticipated damage to the space or maintenance required (grass, footpaths, facilities, etc)**

Vital

### **Do you think we have left any important factors out?**

This is a great starting point. I think if you create too many factors then it gets too complicated.

### **Please tell us your reasons for your responses.**

Who is making the booking - vital because a difference in fee should exist between a NFP and a for profit entity .

Whether alcohol is being provided - there is greater risk of damage to the venue if people are intoxicated, therefore this should reflect in the fee.

Anticipated damage - essentially these fees are covering repairs and maintenance, so if an event is anticipating damage to the surround then they should be held accountable for the cost of this damage/repair work.

**Council will also retain several other ways of managing fees, such as the ability to waive them entirely, or take refundable deposits. If you want to make any comment on these, please do so here.**

As long as it is transparent and there is common fairness around like-minded bookings - as in the payscale is the same - then there shouldn't be a problem with having autonomy to waive fees and/or have refundable deposits.

### **Further comments**

I cannot stress enough how our recent experience with the Majestic Square protest found major flaws and holes in what the bylaw can and cannot do.

At this very moment, Council cannot step in to shut down any event in a public space even if it's sole purpose is to spread hate and incite harm against a minority group.

Is that really where the Council wants it's line in the sand to be? That it supports all groups and activities even if they are to the detriment of another?

### **Submission method**

Online



# Public Parks, Places, and Reserves

**ID** 13  
**reference** 381070347235801

Not Speaking

**First name** Rory  
**Last name** Smith

## KEY ISSUES

**Do you agree that a public places bylaw is still required to manage public places?**

I support keeping a bylaw controlling public places

**Do you support the updated bylaw?**

I support the changes proposed to the bylaw

**What sort of fee do you think should be charged for bookings?**

I support a sliding fee (starting at free)

**If a fixed base fee or sliding fee is chosen, Please rate the below options as to how important you think they should be in setting a booking fee.**

**Who is making the booking (private business, community group, not-for-profit, etc)**

Vital

**Which place is being booked (Majestic Square, Virginia Lake, etc)**

Vital

**Whether alcohol is being provided or sold**

Important

**Expected nuisance to other users (noise, smell, etc)**

Important

**Any anticipated damage to the space or maintenance required (grass, footpaths, facilities, etc)**

Important

**Do you think we have left any important factors out?**

**Submission method**

Online

# Public Parks, Places, and Reserves

ID 14  
reference 919071422233802  
First name JR  
Last name Buckingham

Not Speaking

## KEY ISSUES

### Do you agree that a public places bylaw is still required to manage public places?

I support keeping a bylaw controlling public places

### Do you support the updated bylaw?

I support the changes proposed to the bylaw

### What sort of fee do you think should be charged for bookings?

I support a sliding fee (starting at free)

### Please tell us your reasons for your response.

The fee at the moment is completely opaque and just applied for no reason, other councils such as Palmerston north have an venues team who provide support prior to going through a booking process ie a family bbq vs a big fair. This approach should be used in Whanganui. People shouldn't have barriers put in place where a community is activating a space and using an area that otherwise isn't used. Council should be encouraging communities to take pride and use their spaces and not be put off by fees. Council needs to put clear plain English processes in place for people to understand and help people who want to do the right thing.

### If a fixed base fee or sliding fee is chosen, Please rate the below options as to how important you think they should be in setting a booking fee.

#### Who is making the booking (private business, community group, not-for-profit, etc)

Vital

#### Which place is being booked (Majestic Square, Virginia Lake, etc)

Neither important nor unimportant

#### Whether alcohol is being provided or sold

Vital

#### Expected nuisance to other users (noise, smell, etc)

Important

#### Any anticipated damage to the space or maintenance required (grass, footpaths, facilities, etc)

Vital

#### Do you think we have left any important factors out?

How it links to the open spaces and places strategy and outcome. Does the use of the park benefit the community long term or help activate spaces that council does not activate (due to cost, lack of interest). Community led development should be a key consideration in park use

#### Council will also retain several other ways of managing fees, such as the ability to waive them entirely, or take refundable deposits. If you want to make any comment on these, please do so here.

Please make this clear and available to the public. At the moment the \$50 fee is not even in the fees and charges schedule but buried on a web page.

#### Further comments

Commercial rates should apply for those who are making money off the use of a public space ie fairs, paid food trucks, photography and video. This should then help to support community groups using spaces to improve community wellbeing outcomes

#### Submission method

Online

# Public Parks, Places, and Reserves

**ID** 15  
**reference** 697072346232302  
**First name** Jocelyn  
**Last name** Cuming

Not Speaking

## KEY ISSUES

### Do you agree that a public places bylaw is still required to manage public places?

I support keeping a bylaw controlling public places

### Please tell us your reasons for your response.

In relationship to the beach it is very important to be able to control vehicle usage

### Do you support the updated bylaw?

I support the changes proposed to the bylaw

### What do you think are the main issues which the bylaw should regulate?

Protecting the enjoyment for people walking on the beach and dune areas

Protecting the environment

### What sort of fee do you think should be charged for bookings?

I support a sliding fee (starting at free)

### If a fixed base fee or sliding fee is chosen, Please rate the below options as to how important you think they should be in setting a booking fee.

#### Who is making the booking (private business, community group, not-for-profit, etc)

Important

#### Which place is being booked (Majestic Square, Virginia Lake, etc)

Important

#### Whether alcohol is being provided or sold

Vital

#### Expected nuisance to other users (noise, smell, etc)

Vital

#### Any anticipated damage to the space or maintenance required (grass, footpaths, facilities, etc)

Vital

#### Do you think we have left any important factors out?

## Further comments

There needs to be much stronger protection of the beach from all forms of motor vehicles which are dangerous to people and the environment. Vehicles should be totally banned on the beaches. Some councils have done this

## Submission method

Online